

304/316 Stainless Steel 90 Degree Threaded Elbow , Cast Fittings MSS SP-114

Our Product Introduction

Basic Information

- Place of Origin: China
- Brand Name: KASUGAI
- Certification: MSS SP-114, JIS B 0203
- Model Number: CAST Threaded Elbow
- Minimum Order Quantity: 5ton
- Price: To be negotiated
- Packaging Details: Seaworthy Packing
- Delivery Time: 60-90 days
- Payment Terms: ,T/T,L/C,D/P
- Supply Ability: 100 t per month

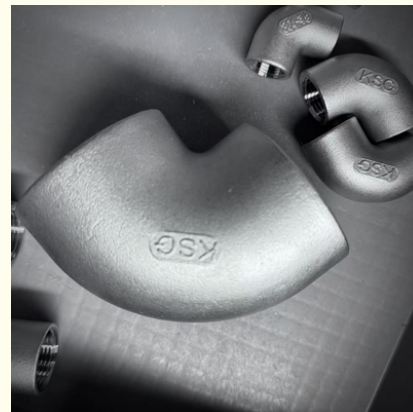

Product Specification



More Images



for more products please visit us on flangespipefittings.com

Product Description

The **304/316 Stainless Steel Cast 90 Degree Threaded Elbow, Cast Fittings MSS SP-114** is a high-quality pipe fitting designed to change the direction of fluid flow by 90 degrees. Manufactured according to **MSS SP-114 standards**, this threaded elbow provides reliable performance in demanding piping systems across multiple industries, including oil & gas, chemical, marine, water treatment, and food processing.

Key Features & Benefits

- Premium Material Selection:** Available in **304/304L** and **316/316L** stainless steel. 304 stainless steel offers very good corrosion resistance, while 316 stainless steel provides excellent corrosion resistance, making it suitable for more aggressive environments.
- High-Pressure Resistance:** Designed to withstand working pressures up to **150LBS** (300 psi @ 72°F) and can handle steam pressures up to 150 psi @ 350°F.
- Wide Temperature Range:** Suitable for a broad spectrum of operating temperatures, typically from **-20°C to +220°C**, with some variants capable of withstanding even higher extremes.
- Precision Manufacturing:** Produced using **investment casting techniques** (also known as precision casting or silica sol casting) and machined with **CNC** lathes. This ensures precise threads and dimensional accuracy.
- Compliant & Certified:** Complies with international standards including **MSS SP-114**, **JIS B 0203**, ISO4144, and EN10241.
- Versatile Application:** Compatible with a wide range of media including **air, steam, kerosene, water, oil, and other fluids**.

Technical Specification

AISI 304/L Chemical Composition (%)

Grade	C, max	Cr	Mn, max	Ni	P, max	S, max	Si, max
AISI 304	0.08	18~20	2	8~10.5	0.045	0.03	1
AISI 304L	0.03	18~20	2	8~12	0.045	0.03	1

AISI 304/L Mechanical Properties

Mechanical Properties	304	304L
Hardness, Knoop	138	158
Hardness, Rockwell B	70	82
Hardness, Vickers	129	159
Tensile Strength, Ultimate	505 MPa	564 MPa
Tensile Strength, Yield	215 MPa	210 MPa
Elongation at Break	70%	58%
Modulus of Elasticity	193~200 GPa	193~200 GPa
Charpy Impact	325 J	216J

NPS	Center-to-End Elbows, Tees & Crosses	Center-to-End 45° Elbows	Length of Thread ^(b) (min.)	Width of Band (min.)	Metal Thickness ^(a)	Outside Dia. of Band (min.)
	A	C	B	E	G	H
1/8	0.81	0.69	0.25	0.20	0.09	0.75
1/4	0.81	0.69	0.32	0.20	0.09	0.84
3/8	0.93	0.81	0.36	0.21	0.10	1.01
1/2	1.12	0.87	0.43	0.25	0.10	1.20
3/4	1.31	1.00	0.50	0.27	0.12	1.46
1	1.50	1.12	0.58	0.30	0.13	1.77
1 1/4	1.75	1.31	0.67	0.34	0.14	2.15
1 1/2	1.93	1.43	0.70	0.37	0.15	2.43
2	2.25	1.68	0.75	0.42	0.17	2.96
2 1/2	2.68	1.93	0.92	0.48	0.2	3.31

3	3.06	2.18	0.98	0.55	0.23	4.00
4	3.81	2.62	1.08	0.66	0.26	5.06

NOTES:

(a) Patterns shall be designed to produce castings of metal thickness given in the Table. Metal thickness at no point shall be less than 90% of values given in the Table.

(b) The length of thread may extend beyond the width of band. However, minimum metal thickness (G) must be maintained at the end of the thread.

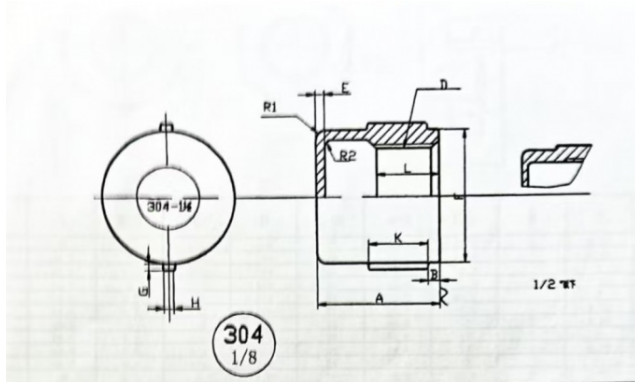

Frequently Asked Questions (FAQ)

Q1: Are these elbows compliant with international standards?

A: Yes. Our 90-degree threaded elbows are manufactured to comply with **MSS SP-114JIS**, , and other relevant standards such as ISO4144, ensuring global quality and compatibility.

Q2: What thread types are available?

A: We offer elbows with various international thread standards including **NPT (National Pipe Taper)**, **BSP (British Standard Pipe)**, and **BSPT (British Standard Pipe Taper)**. Please specify your requirement when ordering.

Q3: What industries are these cast elbows commonly used in?

A: Their durability and corrosion resistance make them suitable for a wide range of industries including **chemical processing**, **oil & gas**, **power generation**, **shipbuilding**, **food and beverage**, **pharmaceutical**, and **water treatment**.

Q4: What is the lead time for orders?

A6: Lead times vary based on order quantity and specification. Generally, Our standard lead time is approximately **60-90 days**. Contact us for specific timing related to your order.

Kasugai Group supply pipe fittings, steel pipes and flanges products more than 100 years, If you want to know more about our piping products, please email us: zhangying@kasugai-group.co.jp

KASUGAI Kasugai Shanghai Co., Ltd.

+8109093329324 zhangying@kasugai-group.co.jp flangespipefittings.com

Rm.8415, Bldg. A8, No. 808 Hongqiao Road, Xuhui District, Shanghai 200030, Chia