

AISI 304 MSS SP-114 CL1000 Stainless Steel Cast Threaded Square Head Plug

Our Product Introduction

Basic Information

- Place of Origin: CHINA
- Brand Name: KASUGAI
- Certification: ISO-9001; PED; AD 2000
- Model Number: AISI 304 MSS SP-114 CL1000 Stainless Steel Cast Threaded Square Head Plug
- Minimum Order Quantity: TO BE NEGOTIATED
- Price: PER BASE MATERIAL PRICE
- Packaging Details: SEAWORTHY PACKING
- Delivery Time: 60 DAYS FOR ONE CONTAINER
- Payment Terms: L / C , T / T, MoneyGram
- Supply Ability: 100 TONS / MONTH



Product Specification

- Product Name: AISI 304 MSS SP-114 CL1000 1/4" Stainless Steel Cast Threaded Square Head Plug
- Size Range: 1/8" To 4"
- Thread Type: ASME B1.20.1(NPT), BS 21 (NSPT), DIN2999/259
- Pressure Class: Class 1000 NPT
- Standards: AISI 304/L
- Dimensions: MSS SP-114-2018
- Highlight: **Cast Threaded Square Head Plug, AISI 304 Threaded Square Head Plug**

for more products please visit us on flangespipefittings.com

Product Description

AISI 304 MSS SP-114 CL1000 Stainless Steel Cast Threaded Square Head Plug

Product Information

- The plug features male threads on the outside and a square head on one end for easy installation and removal using a wrench or a socket.
- It is used to close off a pipe or fitting securely in a threaded system.
- Regular inspection for leaks or signs of corrosion is recommended to ensure the integrity of the system.
- Periodic cleaning can help maintain the appearance and performance of the stainless steel square head plug.

Product Name	AISI 304 MSS SP-114 CL1000 Stainless Steel Cast Threaded Square Head Plug
Thread Types	ASME B1.20.1(NPT), B S 21 (NSPT), DIN2999/259
Dimensions	MSS SP-114
Size Range	1/8" to 4"
Pressure Class	Class 1000 NPT
Materials	AISI 304/L

Advantages:

- **Corrosion Resistance:** Stainless steel construction provides excellent resistance to corrosion and rust.
- **Durability:** Offers longevity and strength, ensuring a reliable closure for pipes or fittings.
- **Easy Installation:** The square head design allows for easy tightening and removal using standard tools.
- **Secure Closure:** Provides a tight and leak-free seal when properly installed.

AISI 304/L Chemical Composition (%)

Grade	C, max	Cr	Mn, max	Ni	P, max	S, max	Si, max
AISI 304	0.08	18~20	2	8~10.5	0.045	0.03	1
AISI 304L	0.03	18~20	2	8~12	0.045	0.03	1

AISI 304/L Mechanical Properties

Mechanical Properties	304	304L
Hardness, Knoop	138	158
Hardness, Rockwell B	70	82
Hardness, Vickers	129	159
Tensile Strength, Ultimate	505 MPa	564 MPa
Tensile Strength, Yield	215 MPa	210 MPa
Elongation at Break	70%	58%
Modulus of Elasticity	193~200 GPa	193~200 GPa
Charpy Impact	325 J	216J

MSS SP-114 Dimensions of Class 1000 Wrought Thread Square Head Plugs (inches)

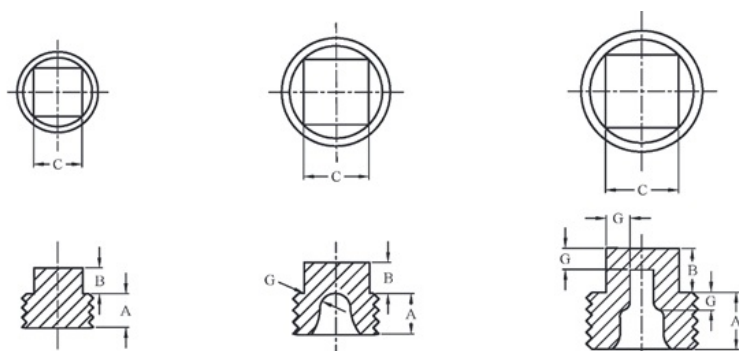

SOLID PLUGS

CORED PLUGS

NPS	Thread Length (min.)	Height of Head (min.)	Nominal Width Across Flats ^(b)	Metal Thickness ^(a)
	A	B	C	G
1/8	0.38	0.25	9/32	0.19
1/4	0.44	0.25	3/8	0.19
3/8	0.50	0.31	7/16	0.19
1/2	0.56	0.38	9/16	0.25
3/4	0.62	0.44	5/8	0.25
1	0.75	0.50	13/16	0.38
1 1/4	0.81	0.56	15/16	0.38
1 1/2	0.81	0.62	1 1/8	0.44
2	0.88	0.69	1 5/16	0.50
2 1/2	1.06	0.75	1 1/2	0.62
3	1.12	0.81	1 11/16	0.75

4	1.25	1.00	2½	0.88
---	------	------	----	------

NOTE:
(a) Manufacturers applied tolerance shall assure dimensions will fit U.S. customary tooling.



+8109093329324 zhangying@kasugai-group.co.jp flangespipefittings.com

Rm.8415, Bldg. A8, No. 808 Hongqiao Road, Xuhui District, Shanghai 200030, Chia